

ULTIMA 22mm Shear Pins for Fused Swivels

ORIGINAL FRAME SIZE 256mm X 383mm

THIRD ANGLE PROJECTION

PRODUCED BY CAD DO NOT MODIFY

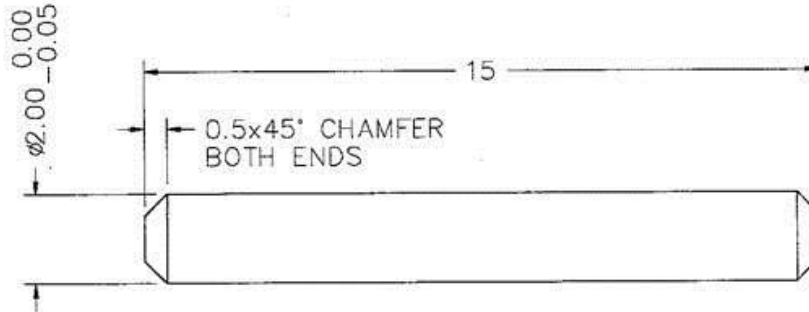
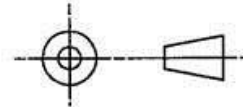

FUSE TABLE				
FUSE No	RATING	MATERIAL	HEAT TREATMENT	FINISH
2A	2KN	BRASS C2121 3Pb TO SPEC BS2874	NONE	CLEAN
3A	3KN	MILD STEEL	NONE	ENGINEER BLUED
4A	4KN	SILVER STEEL	NONE	CLEAN
5A	5KN	SILVER STEEL	HARDENED TO 340/360 BRINELL	APPROXIMATELY 50% OF THE BLACK HARDENING TO BE REMOVED BY LIGHT SAND BLASTING
6A	6KN	SILVER STEEL	HARDENED TO 390/410 BRINELL	COPPER PLATED 0.025 THICK
8A	8KN	SILVER STEEL	HARDENED TO 490/510 BRINELL	CHEMICALLY BLACKED

NOTE:

- SEE BT SPEC TL476 FOR GENERAL REQUIREMENTS.

DIMS IN mm

© British Telecommunications plc 1991

DO NOT SCALE
ORIGINAL SCALE 5:1

		5A ADDED TO FUSE TABLE J.E.P M.S / I.J 20/3/96		B	REFERENCES SPEC TL476 SPEC BS2874
		SPEC TL476 WAS MAT000. TITLE CHANGE. RFG JHC 26/3/92		A	
		AMENDMENT		ISSUE	
A3	DRN RFG CKD RFG	MATERIAL AS SHOWN	FINISH AS SHOWN	TOLERANCES UNLESS OTHERWISE STATED TO BE: ONE DEC PLACE ±0.2 NIL DEC PLACE ±0.5	
A4	CERTIFICATION J H CARR DATE 9/10/91	FUSE SWIVEL			
BT WORLDWIDE NETWORKS (NYH2.1)				CN14614	

14614C