



**GORILLA STANDS**  
**Tri-Splicer**



- All splicing essentials close to hand.
- Ultra-convenient node mounting.
- Stable and sturdy construction.
- No bending down, shelf for splicer and other tools.
- Fast set up and pack down.



Designed and developed in collaboration with experienced fibre optic engineers.

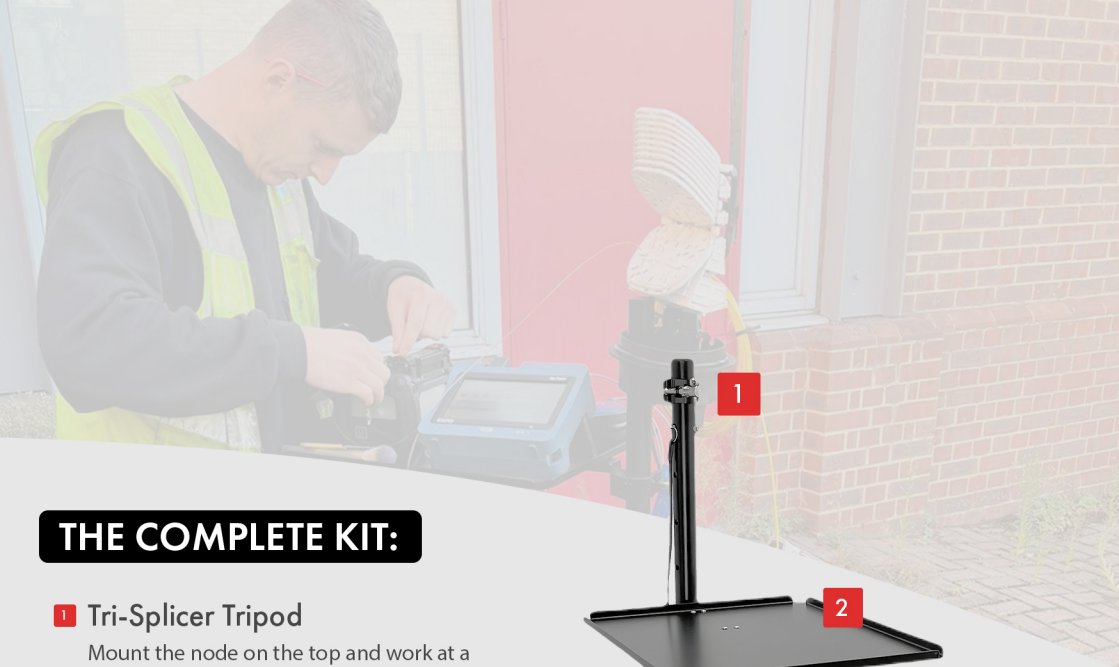

## THE COMPLETE KIT:

### 1 Tri-Splicer Tripod

Mount the node on the top and work at a comfortable height, from 112cm to 183cm. This tripod stands across manholes with ease thanks to its wide legspan of 100cm.

### 2 Tri-Splicer Shelf

Keep all your tools to hand and close to the node with Tri-Splicer's shelf which can easily accommodate a splicer and a whole lot more, measuring 45cm x 35cm.

### 3 Mini Tri-Splicer Tripod

If you're working close to the ground or in a low ceiling environment then the included mini tripod will have you working comfortably.

### 4 Carry Bag

A strong carry bag is included for easy transport of the Tri-Splicer, conveniently fitting the large tripod, mini tripod, and shelf with it's 2 compartments.

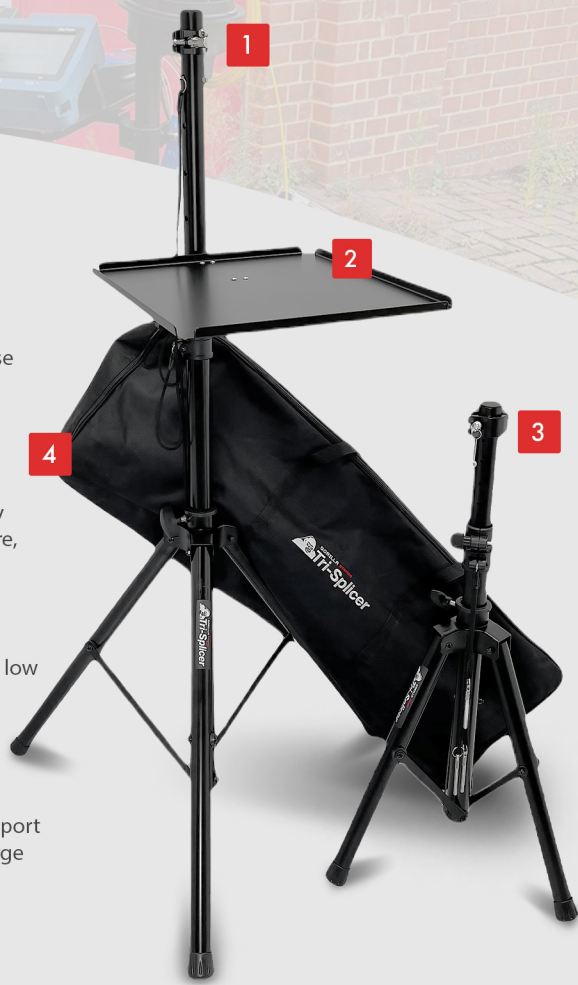



## FOR FIBRE ENGINEERS, BY FIBRE ENGINEERS



Tri-Splicer helps improve your posture by keeping key equipment to hand and in a comfortable position, eliminating the need to bend down frequently.



Tri-Splicer allows you to work faster and more efficiently by keeping the node stable and upright, whilst giving you a platform to work from.



# WORK SMARTER.





# SPECIFICATIONS:

## Tri-Splicer Tripod

- Minimum height (assembled) to the top: 112cm
- Maximum height (assembled) to the top: 183cm
- 13 height adjustment safety pin holes
- 3 safety pins, plus a clamp for extra fine tuning of the node height position
- Maximum leg span: 100cm

## Mini Tri-Splicer Tripod

- Minimum height (assembled) to the top: 82cm
- Maximum height (assembled) to the top: 92cm
- 5 height adjustment safety pin holes
- 3 safety pins, plus a clamp for extra fine tuning of the node height position
- Maximum leg span: 70cm

## Tri-Splicer Carry Bag

- Length: 104cm
- Width: 35cm
- Depth: 17cm
- Material: Heavy duty canvas
- Padded compartments: 2
- Carry handles: 2

## Tri-Splicer Shelf

- Shelf length: 45cm
- Shelf width: 35cm
- Shelf is removable

Contact us:

01206 845125

[sales@audiovisualcommodity.co.uk](mailto:sales@audiovisualcommodity.co.uk)

